

USE INSTRUCTION HANDBOOK

ISTRUZIONI DI MONTAGGIO

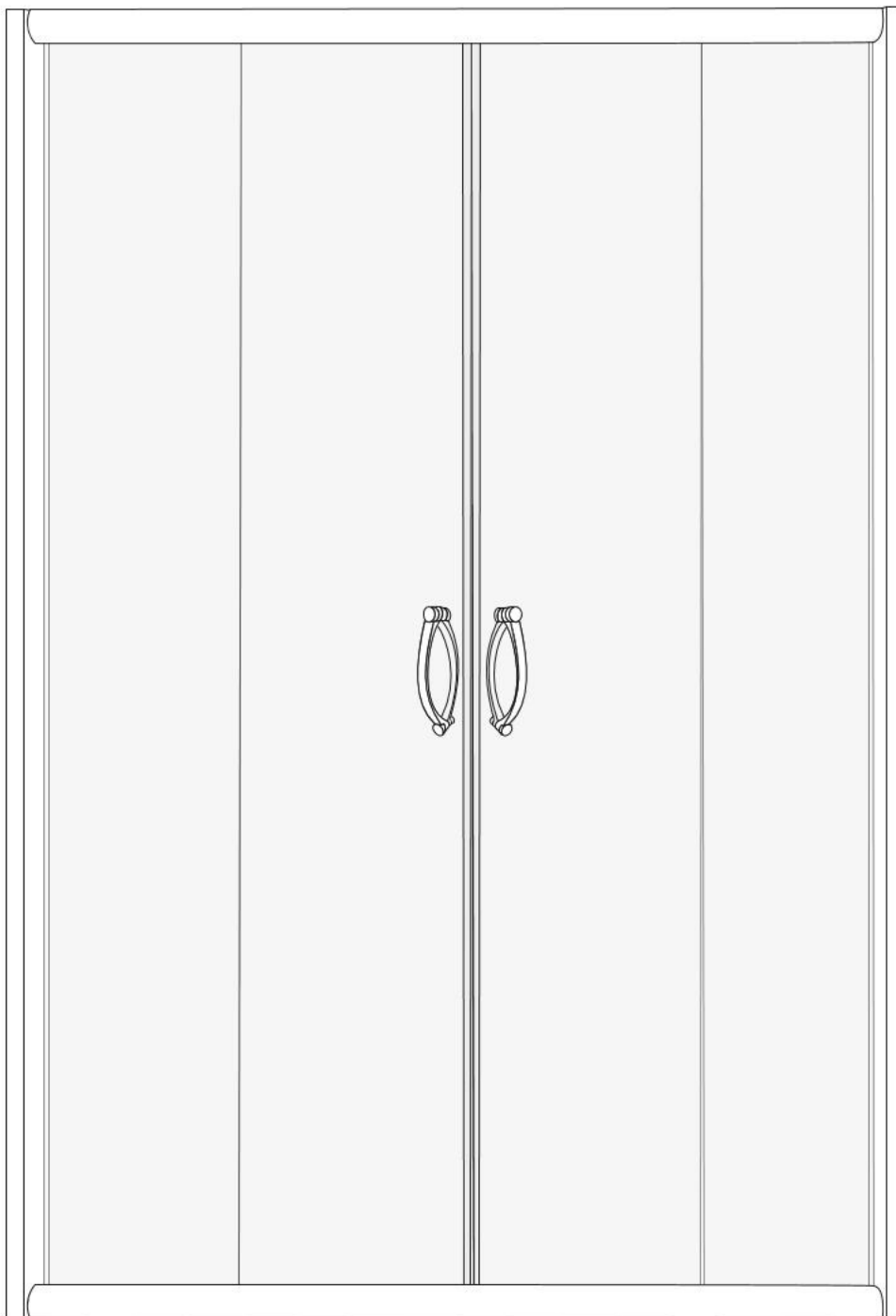

PORTE NICCHIA GIADA GRANDI

**SIZE: 160*185
170*185
180*185**

TOOLS REQUIRED(NOT SUPPLIED)

when you're ready to start,make sure that you have the following tools to hand,plenty of space and a clean dry area for assembly.

Two people are needed. Please note:although these instructions are comprehensive,We always recommend that a technically competent installer should undertake installation.



Drill beat head
5. 5mm

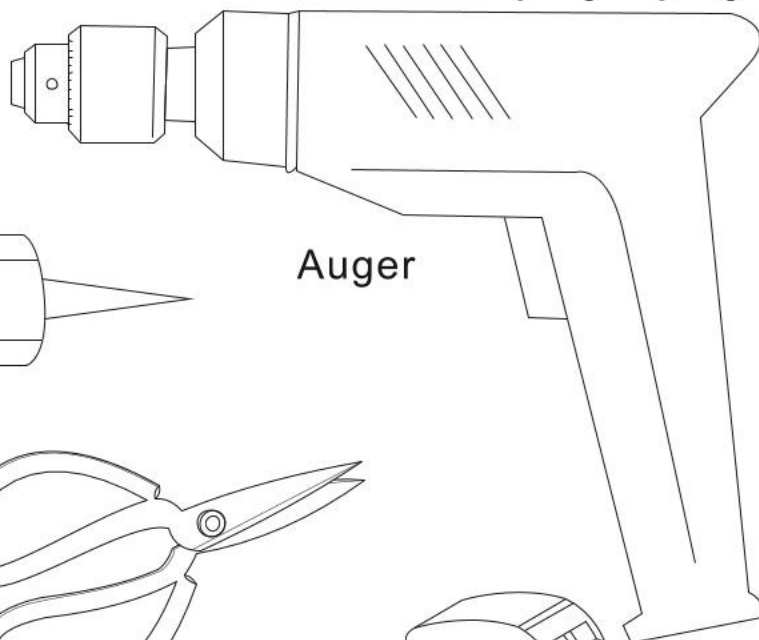

Auger

Sanitary Silicone

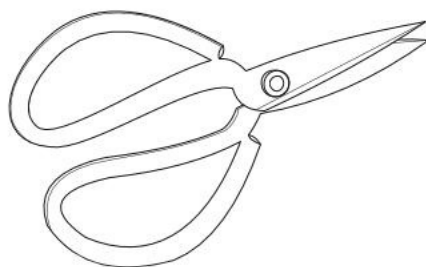
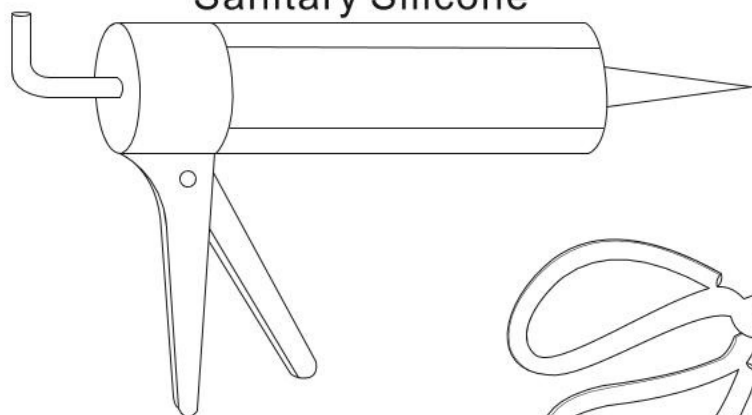

Forfex

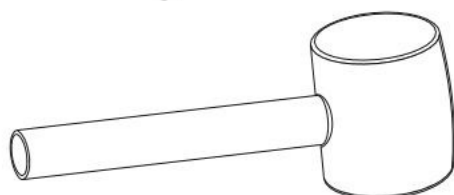

Hammer

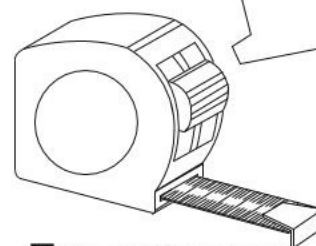

Tape measure



Board

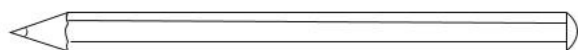

Pencil

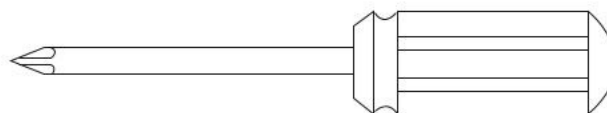

Magnetic crosshead schrewdriver

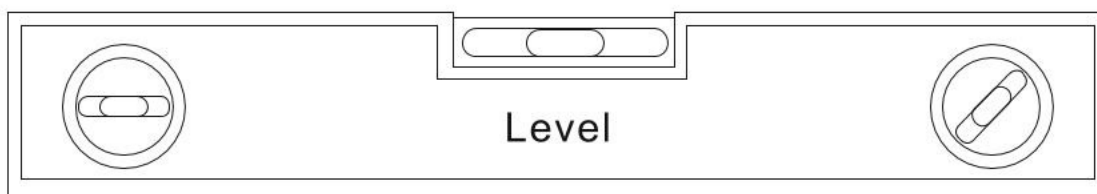

Level

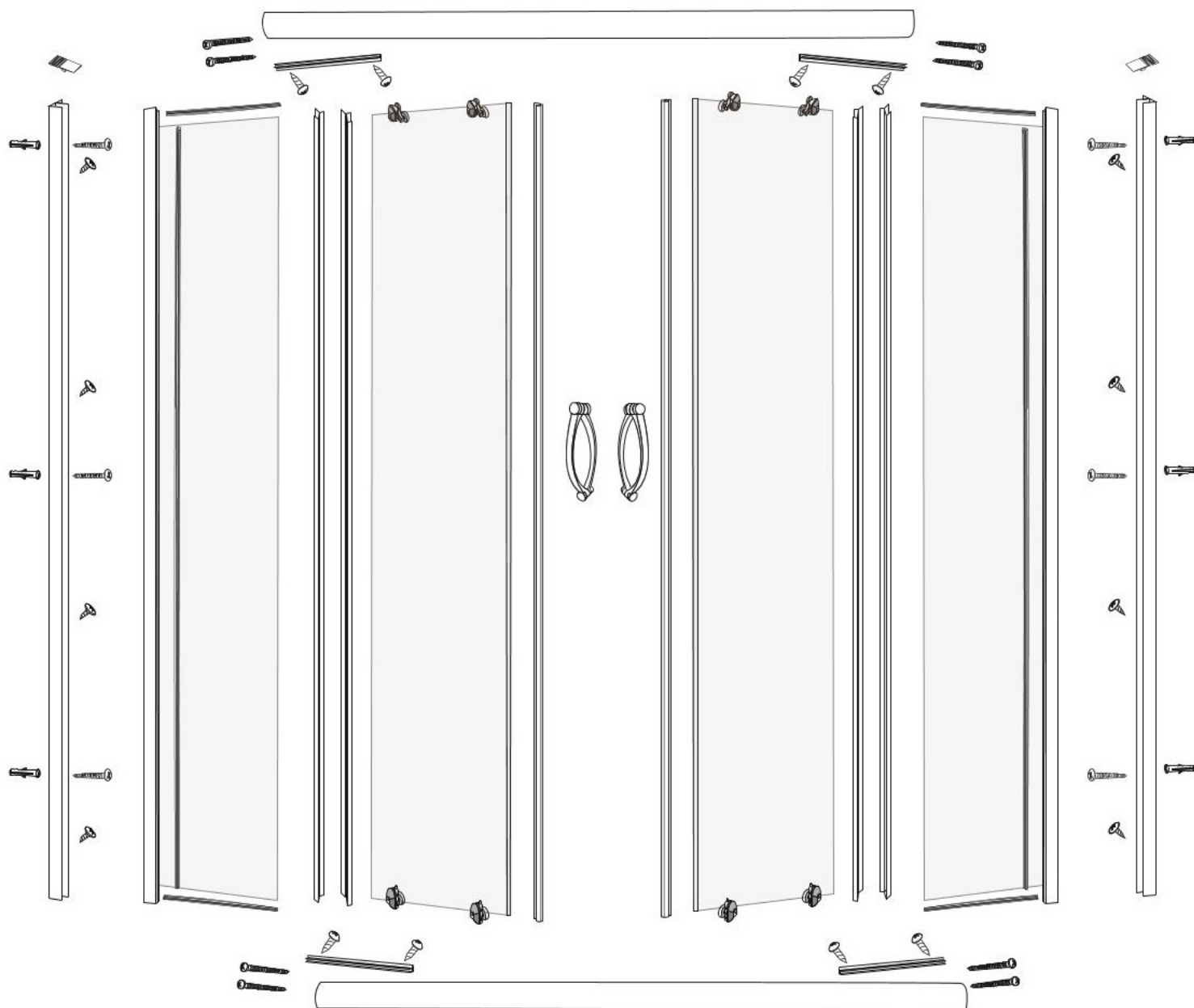

4PCS

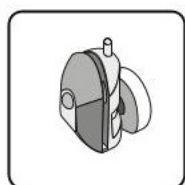

4PCS



4PCS

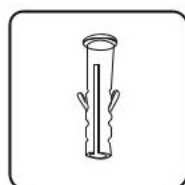

6PCS

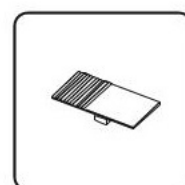

2PCS

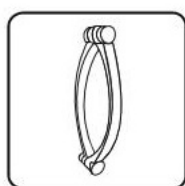

2PCS



4x25mm
8PCS



4x25mm
6PCS



4x12mm
8PCS

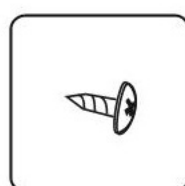

4x10mm
10PCS

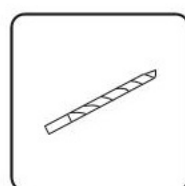

3mm

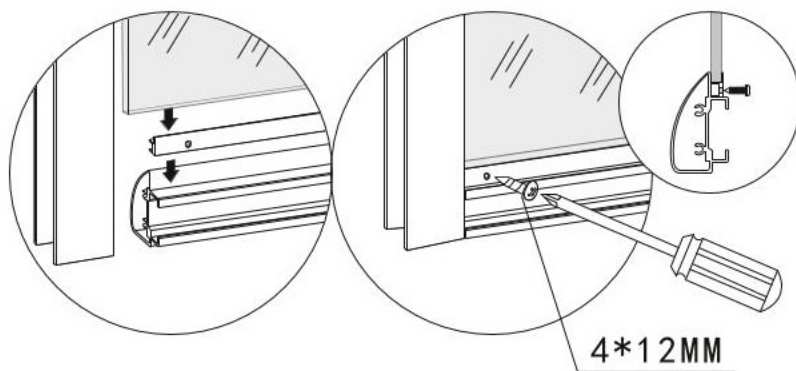
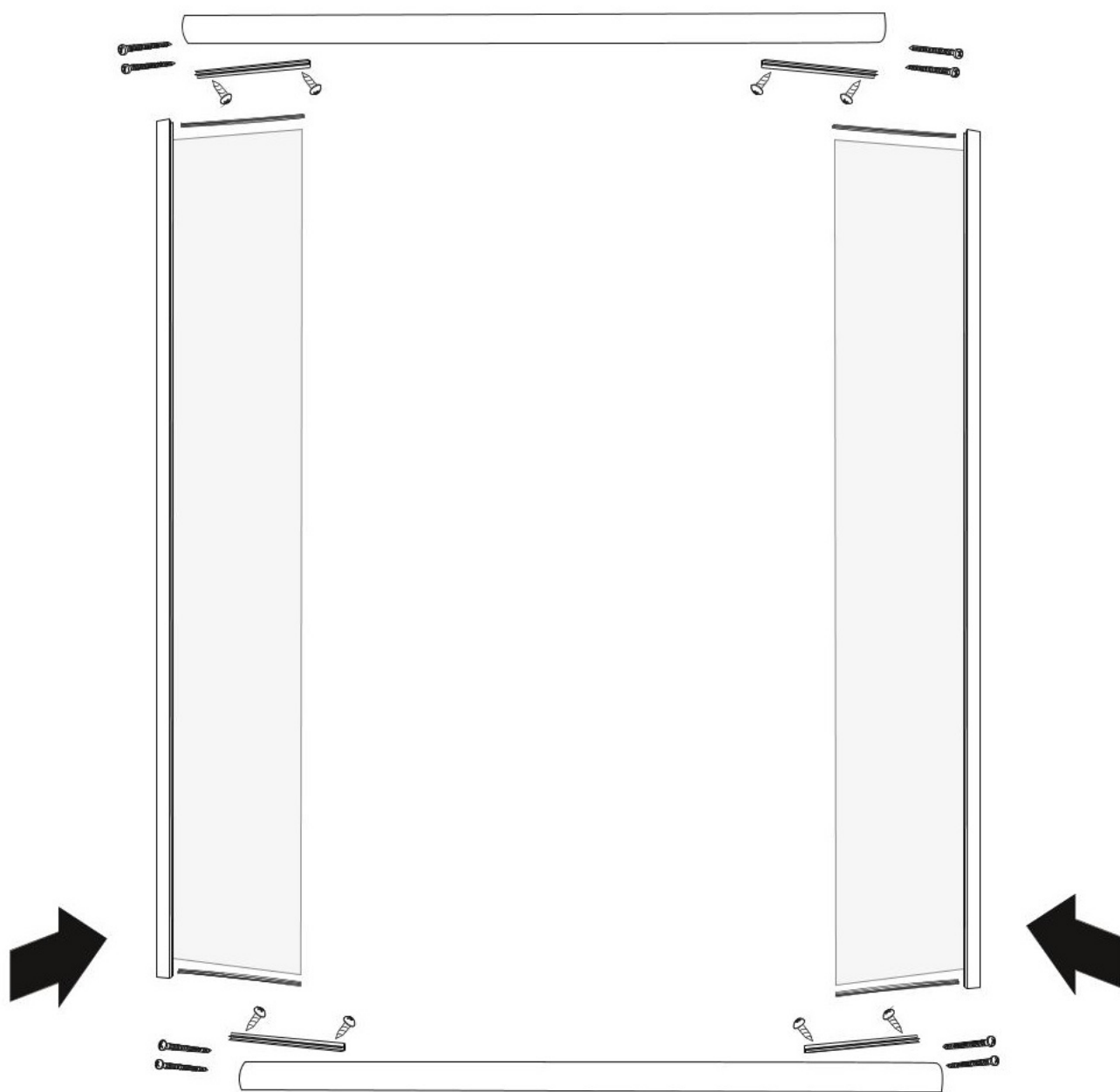

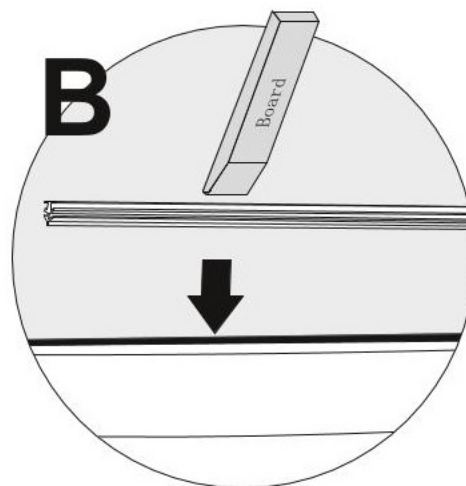
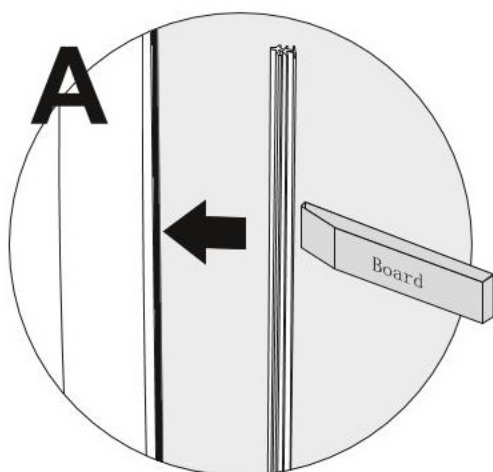
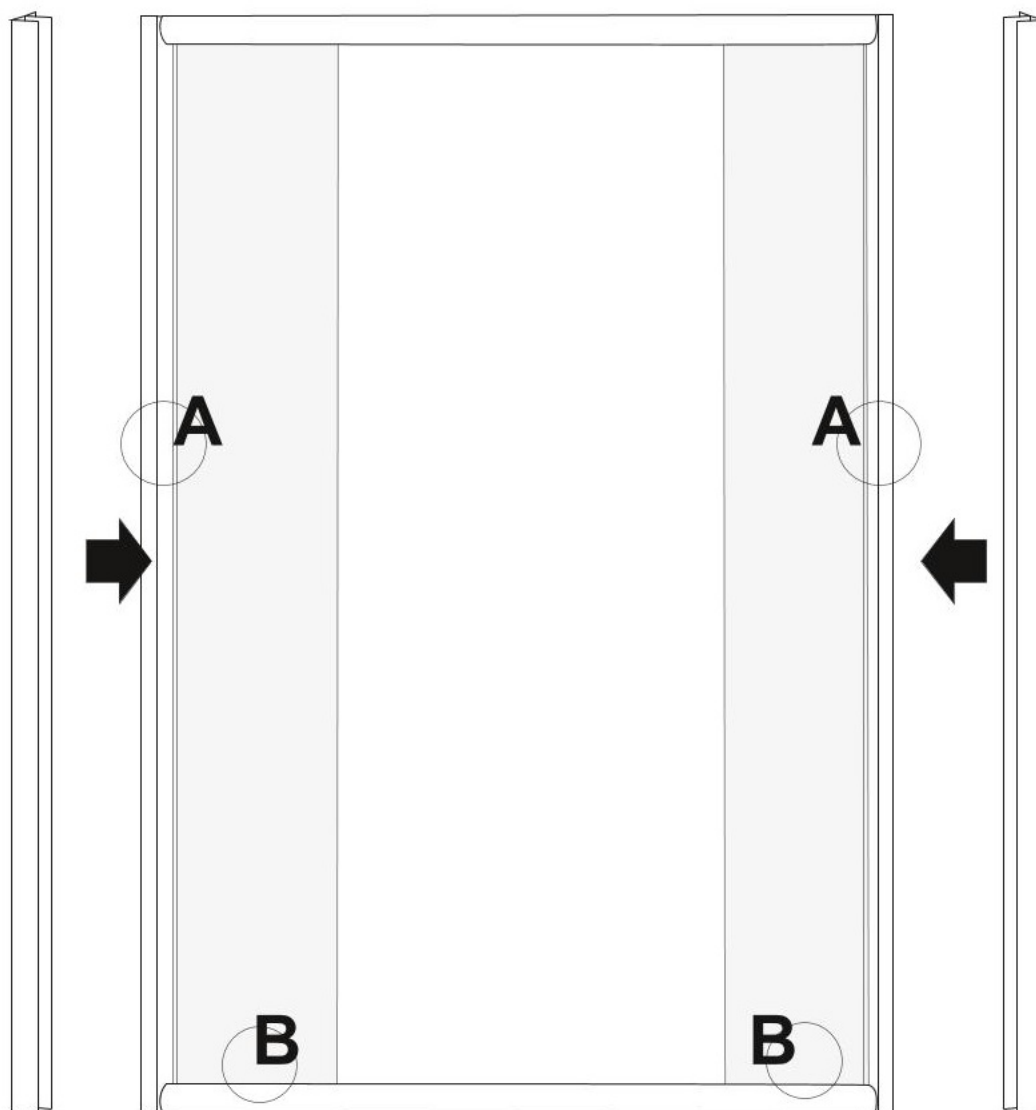

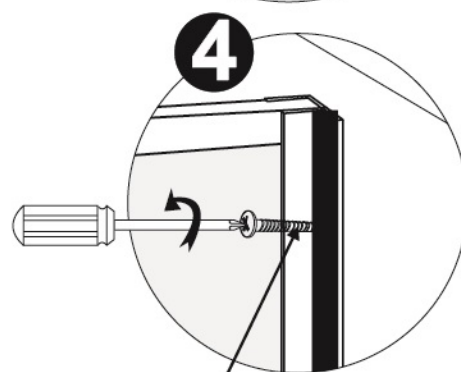
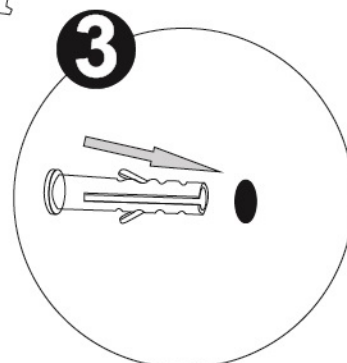
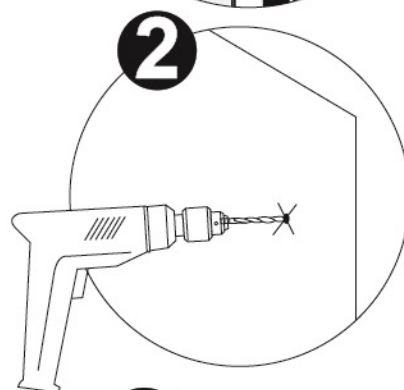
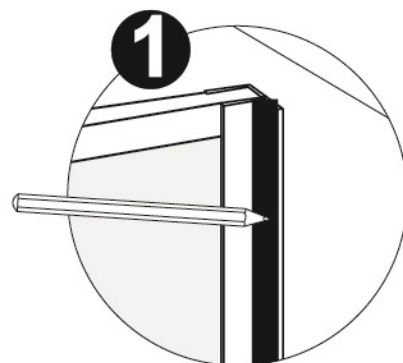
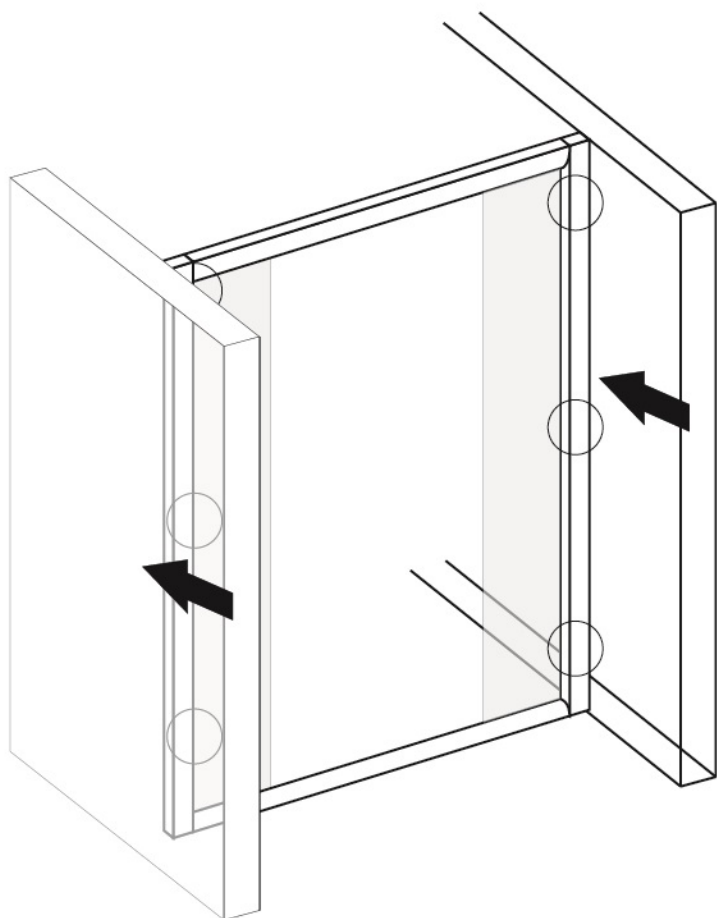

4*25 mm

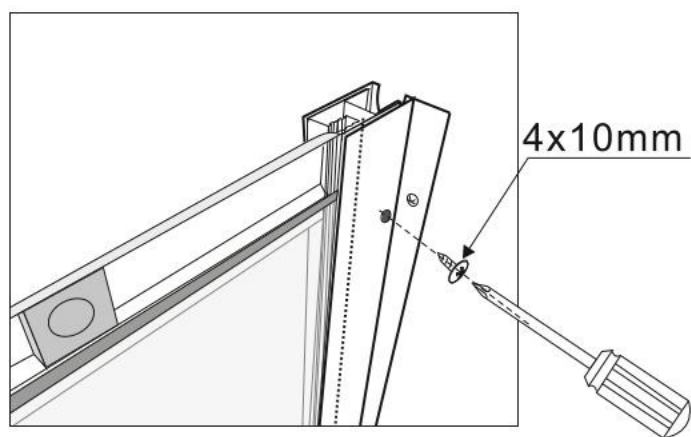
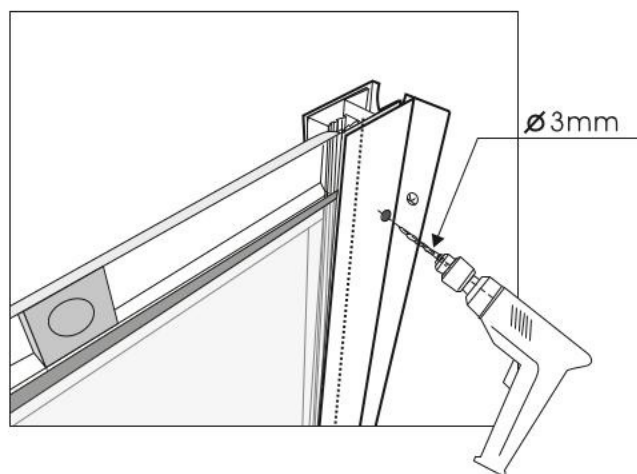
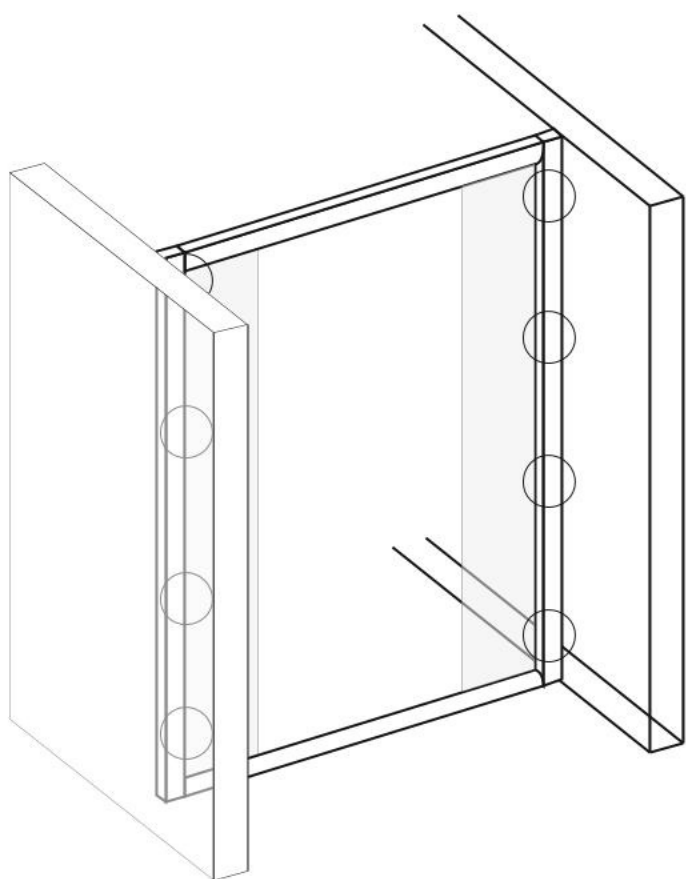

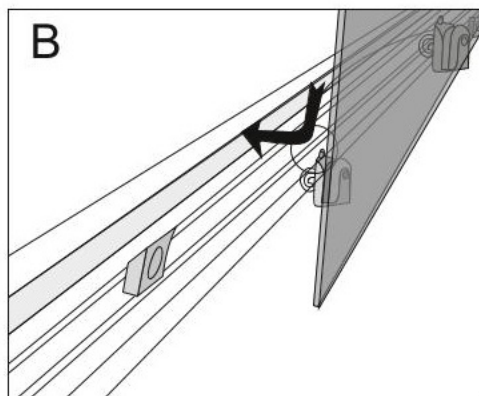
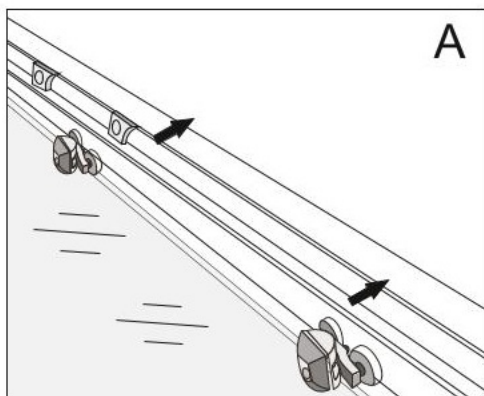
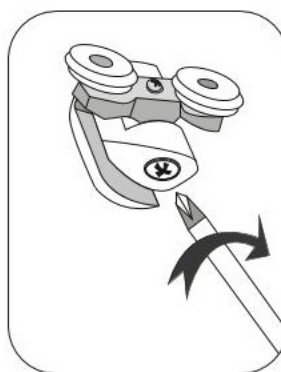
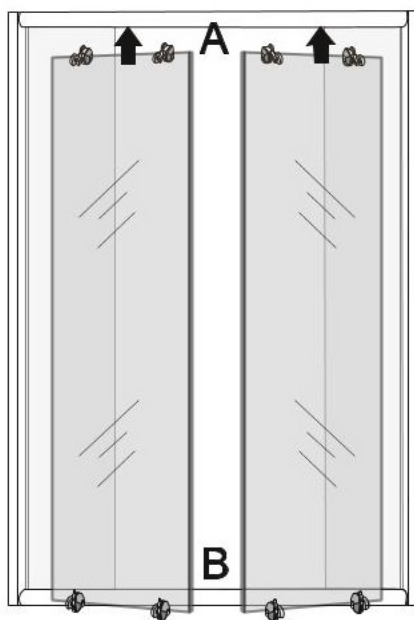
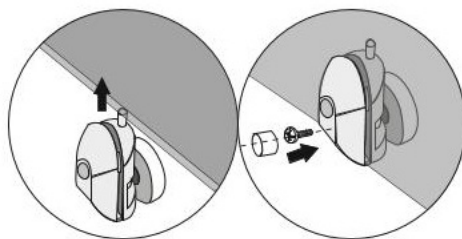
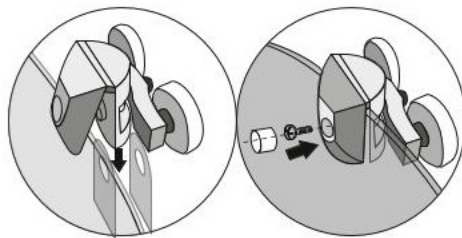
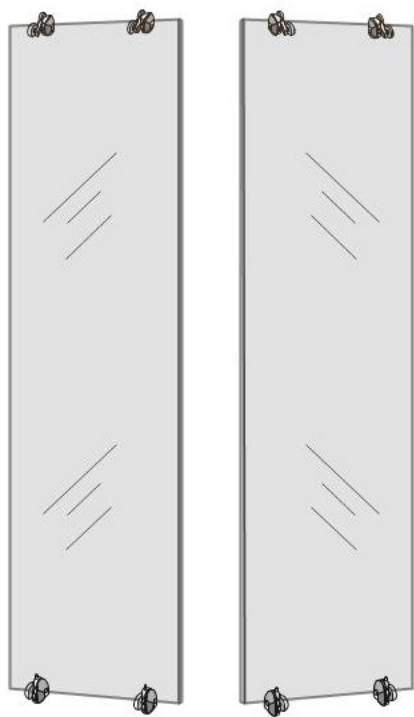

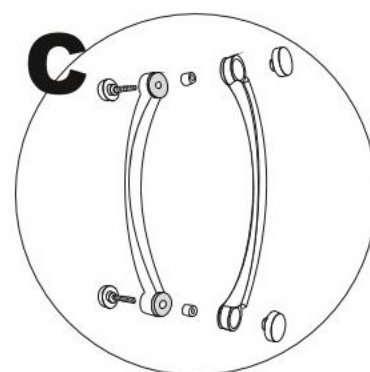
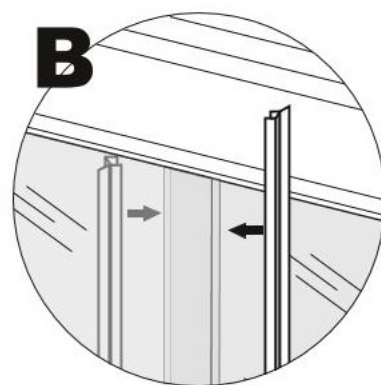
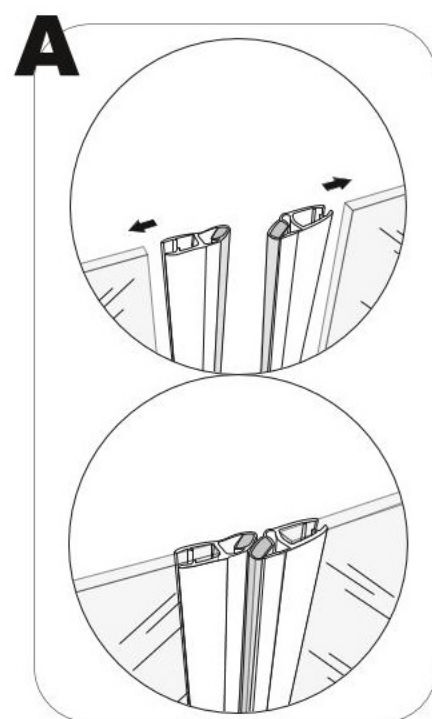
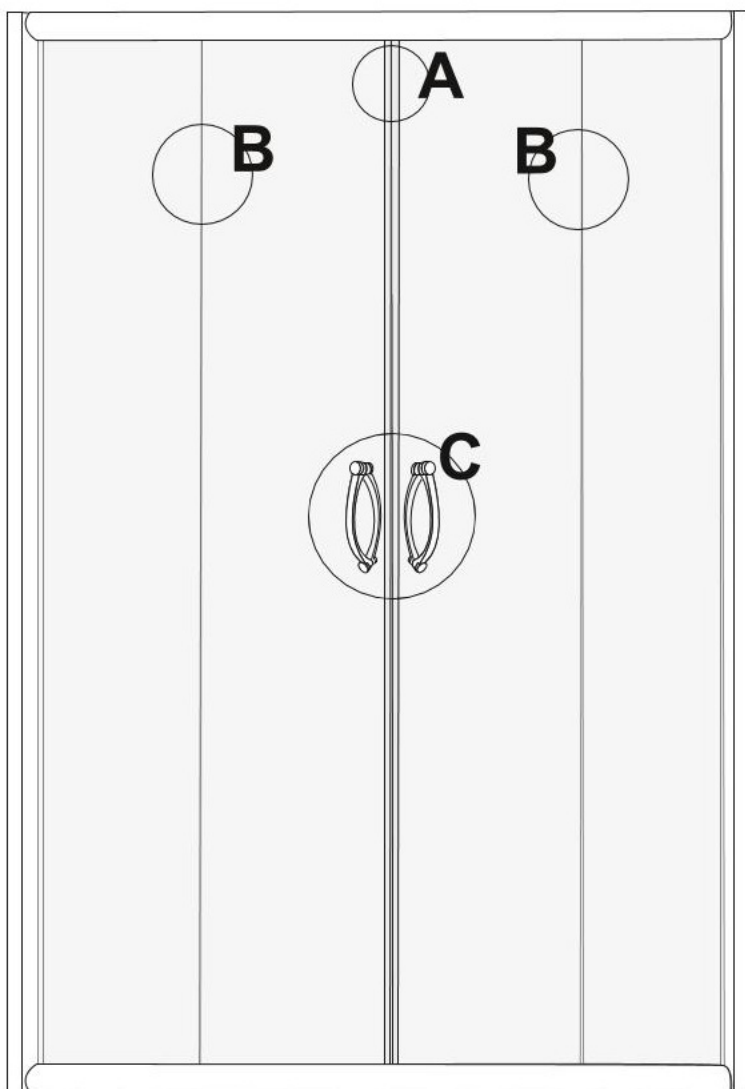

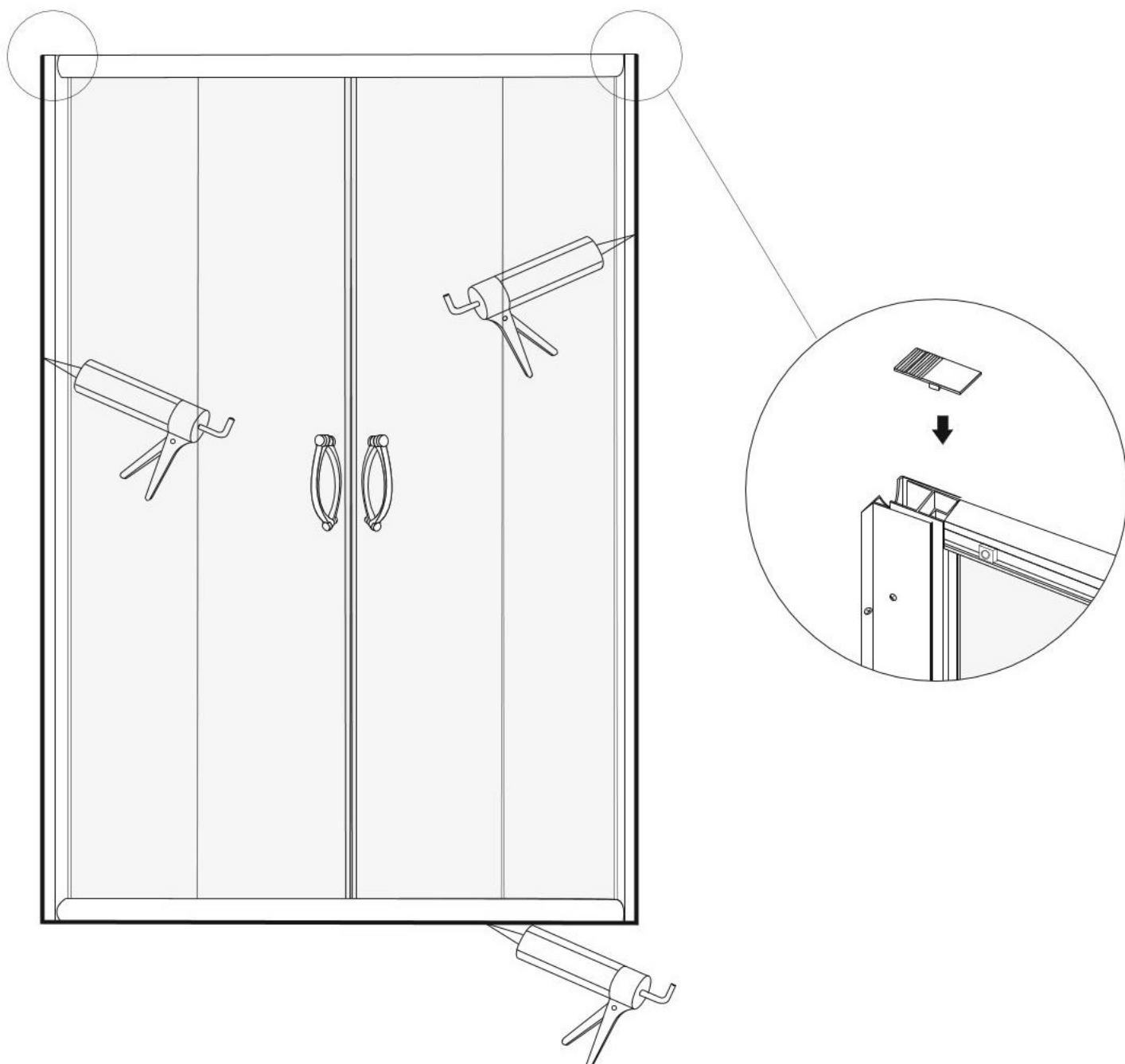

Warning: Don't use the shower enclosure until after at least 24 hours, so that the silica gel can be totally dry.

